



MA501t | Install Instructions For:

MA501t

Box Contents

- 1- Amplifier
- 1- 32V, 1.6A power supply with power cord
- 1- Four-pin Euroblock connectors
- 2- Three-pin Euroblock connectors
- 1- Mounting bracket

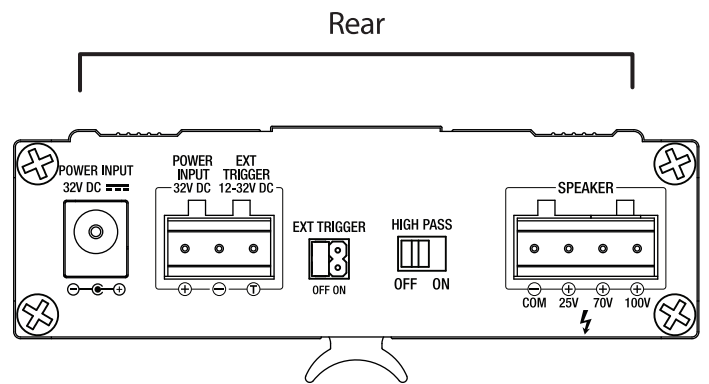
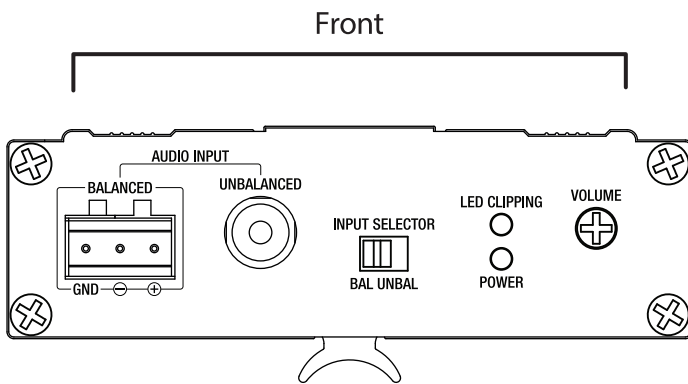
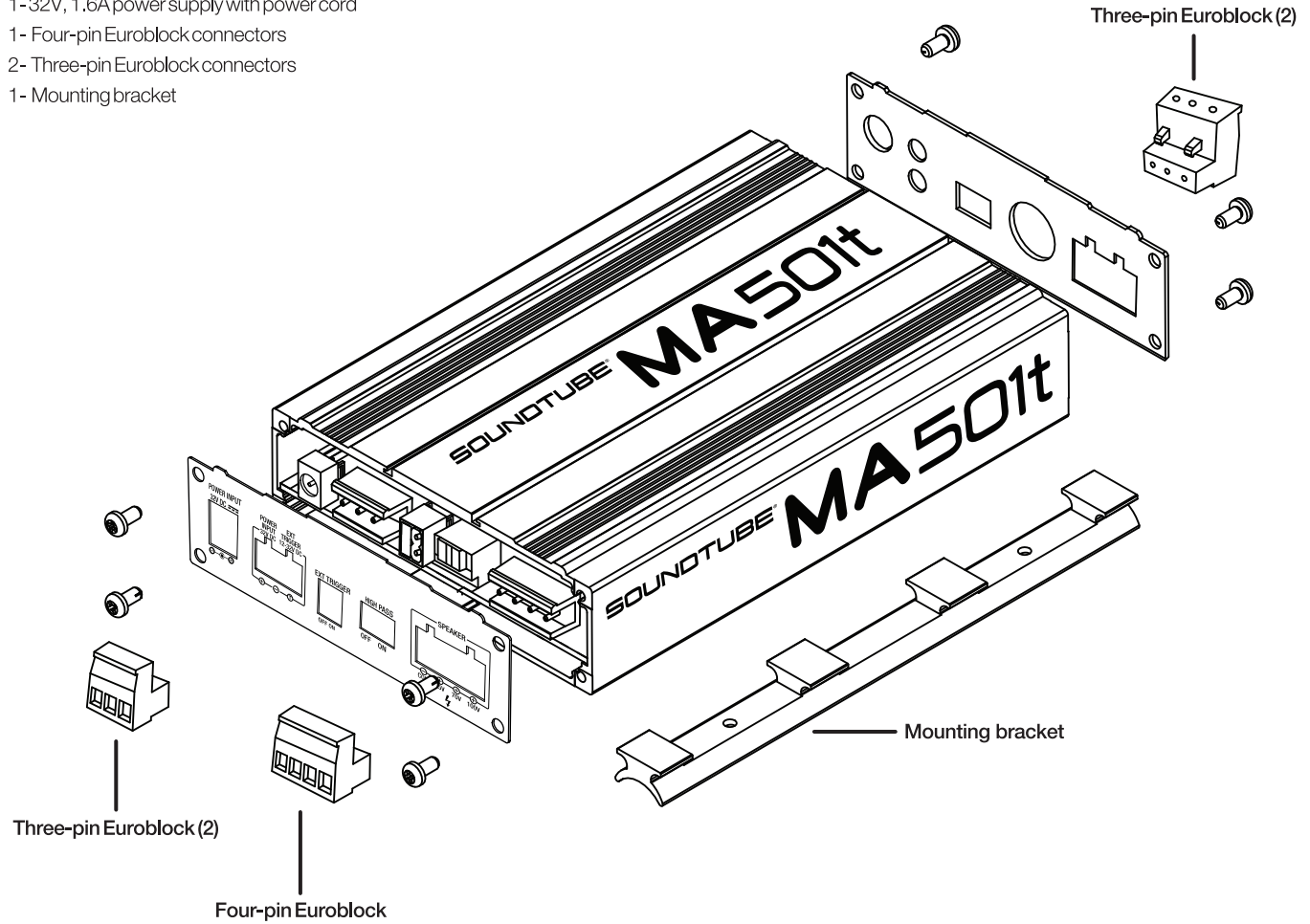

1.435.647.9555 | 800.647.TUBE | www.soundtube.com

©2015 SoundTube Entertainment, Inc. All rights reserved. PN INS-MA501t Rev12.03.15

Warning

SoundTube products must be installed by a professional audio installer/contractor. For safety and for optimum audio performance, installer must follow all directions issued by SoundTube Entertainment.

Attention

SoundTube produits doivent être installés par un installateur audio / entrepreneur professionnel. Pour la sécurité et pour une performance audio optimale, l'installateur doit suivre toutes les instructions émises par SoundTube Entertainment.

Important Safety Instructions

- 1) Read these instructions.
- 2) Keep these instructions.
- 3) Heed all warnings.
- 4) Follow all instructions.
- 5) Do not use this apparatus near water.
- 6) Clean only with dry cloth.
- 7) Do not block any ventilation openings. Install in accordance with the manufacturer's instructions.
- 8) Do not install near any heat sources such as radiators, heat registers, stoves, or other apparatus (including amplifiers) that produce heat.
- 9) Do not defeat the safety purpose of the polarized or grounding-type plug. A polarized plug has two blades with one wider than the other. A grounding type plug has two blades and a third grounding prong. The wide blade of the third prong are provided for your safety. If the provided plug does not fit into your outlet, consult an electrician for replacement of the obsolete outlet.
- 10) Protect the power cord from being walked on or pinched particularly at plugs, convenience receptacles, and the point where they exit from the apparatus.
- 11) Only use the attachments/accessories specified by the manufacturer.
- 12) Use only with the cart, stand, tripod, bracket or table specified by the manufacturer, or sold with the apparatus. When a cart is used, use caution when moving the cart/apparatus combination to avoid injury from tip-over.
- 13) As a disconnect device, the power plug of the power adaptor should be readily operable.

Consignes de sécurité importantes

- 1) Lire ces instructions.
- 2) Conservez ces instructions.
- 3) Respectez tous les avertissements.
- 4) Suivez toutes les instructions.
- 5) Ne pas utiliser cet appareil près de l'eau.
- 6) Nettoyer seulement avec un chiffon sec.
- 7) Ne pas bloquer les ouvertures de ventilation. Installez conformément aux instructions du fabricant.
- 8) Ne pas installer près de sources de chaleur telles que des radiateurs, registres de chaleur, poêles ou autres appareils (incluant les amplificateurs) qui produisent de la chaleur.
- 9) Ne pas contourner le dispositif de sécurité de la prise polarisée ou de type mise à la terre. Une fiche polarisée possède deux lames dont une plus large que l'autre. Une prise de terre dispose de deux lames et une troisième broche de mise à la terre. La lame large de la troisième broche sont fournies pour votre sécurité. Si la fiche fournie ne rentre maintenant dans votre prise, consultez un électricien pour le remplacement de la prise obsolète.
- 10) Protégez le cordon d'alimentation de marcher sur des pincé, en particulier au niveau des fiches, des prises de courant, et le point où ils sortent de l'appareil.
- 11) Utilisez uniquement les fixations / accessoires spécifiés par le fabricant.
- 12) Utilisez uniquement avec le chariot, stand, trépied, support ou table spécifié par le fabricant, ou vendus avec l'appareil. Quand un chariot est utilisé, faites attention en déplaçant l'ensemble chariot / appareil pour éviter les blessures en cas de chute.
- 13) En tant que dispositif de déconnexion, le cordon d'alimentation de l'adaptateur d'alimentation doit être facilement accessible.

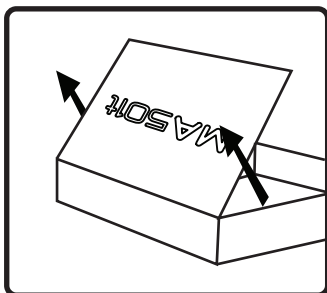

1. Unpack amplifier.

Note: Follow steps 2-5 if using the mounting adapter. If not skip to step 6.

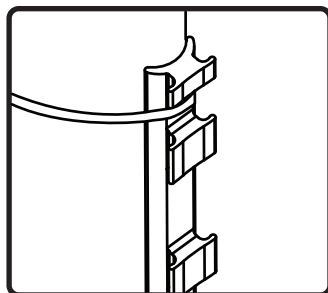

2. Attach mounting bracket to a secure pole or surface using screws or metal strapping.

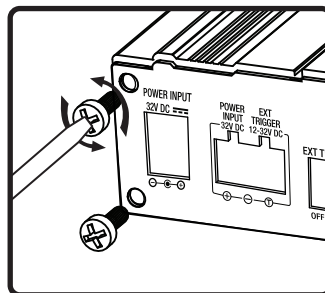

3. To attach mounting bracket, remove all faceplate screws from one side. Lift faceplate and set aside.

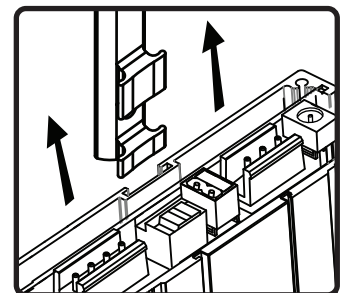

4. Slide mounting bracket into groove on bottom of amplifier enclosure.

MA501t | Install Instructions For:

MA501t

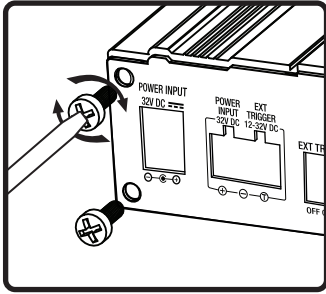

5. Replace faceplate and screws.

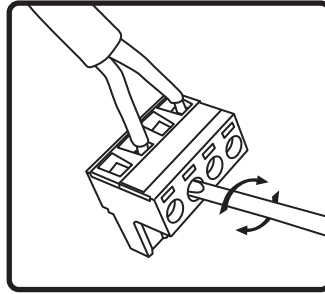

6. Connect wires to 4 pin Euroblock for desired output voltage.

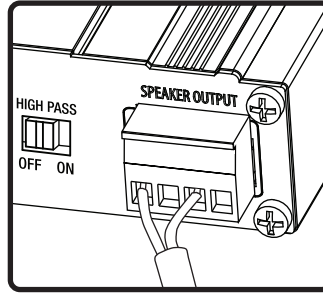

7. Connect speaker Euroblock to the MA501t.

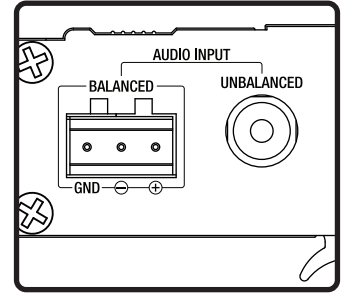

8. THE MA501t accepts audio sources via unbalanced RCA input or balanced euroblock input on the front of the amplifier.

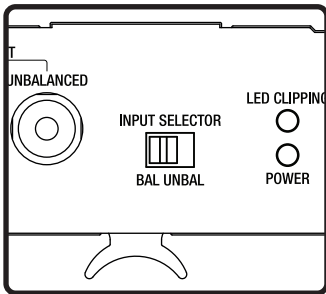

9. Select the input via input selector switch on the front of the MA501t.

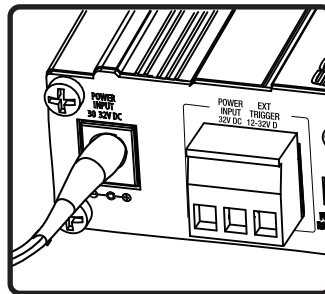

10. The MA501t can be powered either by the hard wired Euroblock connector, or via barrel connector with the included power supply (shown above). Use a safety approved (UL/ETL, etc...) 32V 1.6A power supply.

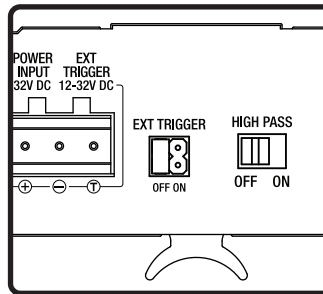

11. The MA501t can be turned on and off with an external 12v-32v DC trigger. To enable, move the jumper to "on."

Note: Amp comes equipped with auto-sensing circuit that idles down after 10 minutes without input signal. Unit powers back up when a signal is detected.

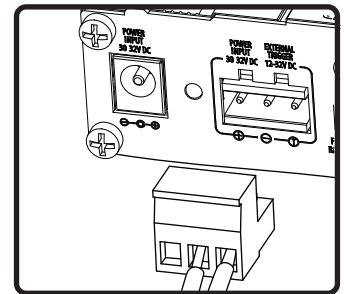

12. If using external trigger, run the trigger positive wire into "T" and the trigger negative wire into "-" using the 3 pin Euroblock. Note: If using both external trigger and hard wired power, both negative wires will share the "-" Euroblock input.

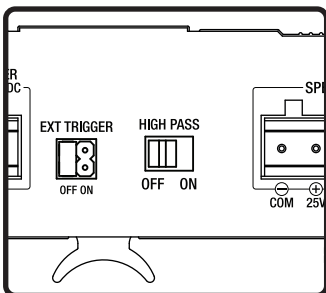

13. If desired, use the high-pass filter to remove low-end frequencies and increase intelligibility when using small speakers.

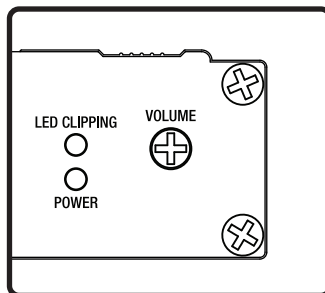

14. Adjust volume with knob on front of amplifier using a small screwdriver.

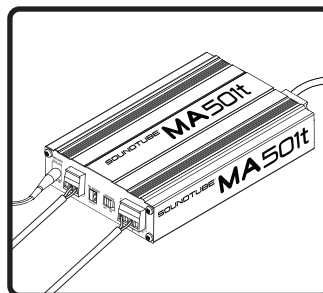

15. Done

FCC Notice

This device complies with Part 15 of the FCC Rules. Operation is subject to the following two conditions: (1) this device may not cause harmful interference, and (2) this device must accept any interference received, including interference that may cause undesired operation.

Le présent appareil est conforme aux CNR d'Industrie Canada applicables aux appareils radio exempts de licence. L'exploitation est autorisée aux deux conditions suivantes : (1) l'appareil ne doit pas produire de brouillage, et (2) l'utilisateur de l'appareil doit accepter tout brouillage radioélectrique subi, même si le brouillage est susceptible d'en compromettre le fonctionnement.

Changes or modifications not expressly approved by the party responsible for compliance could void the user's authority to operate the equipment.

This equipment has been tested and found to comply with the limits for a Class D digital device, pursuant to part 15 of the FCC Rules. These limits are designed to provide reasonable protection against harmful interference in a residential installation. This equipment generates uses and can radiate radio frequency energy and, if not installed and used in accordance with the instructions, may cause harmful interference to radio communications. However, there is no guarantee that interference will not occur in a particular installation. If this equipment does cause harmful interference to radio or television reception, which can be determined by turning the equipment off and on, the user is encouraged to try to correct the interference by one or more of the following measures:

- Reorient or relocate the receiving antenna.
- Increase the separation between the equipment and receiver.
- Connect the equipment into an outlet on a circuit different from that to which the receiver is connected.
- Consult the dealer or an experienced radio/TV technician for help.

Under Industry Canada regulations, this radio transmitter may only operate using an antenna of a type and maximum (or lesser) gain approved for the transmitter by Industry Canada. To reduce potential radio interference to other users, the antenna type and its gain should be so chosen that the equivalent isotropically radiated power (e.i.r.p.) is not more than that necessary for successful communication.

Conformément à la réglementation d'Industrie Canada, le présent émetteur radio peut fonctionner avec une antenne d'un type et d'un gain maximal (ou inférieur) approuvé pour l'émetteur par Industrie Canada. Dans le but de réduire les risques de brouillage radioélectrique à l'intention des autres utilisateurs, il faut choisir le type d'antenne et son gain de sorte que la puissance isotrope rayonnée équivalente (p.i.r.e.) ne dépasse pas l'intensité nécessaire à l'établissement d'une communication satisfaisante.

MPE Notice

To satisfy FCC RF exposure requirements, a separation distance of 20 cm or more should be maintained between the antenna of this device and persons during device operation. To ensure compliance, operations at closer than this distance are not recommended.

Les antennes installées doivent être situées de façon à ce que la population ne puisse y être exposée à une distance de moins de 20 cm. Installer les antennes de façon à ce que le personnel ne puisse approcher à 20 cm ou moins de la position centrale de l'antenne. La FCC des États-Unis stipule que cet appareil doit être en tout temps éloigné d'au moins 20 cm des personnes pendant son fonctionnement.

IC Notice

This device complies with Industry Canada licence-exempt RSS standard(s). Operation is subject to the following two conditions: (1) this device may not cause interference, and (2) this device must accept any interference, including interference that may cause undesired operation of the device.

Le présent appareil est conforme aux CNR d'Industrie Canada applicables aux appareils radio exempts de licence. L'exploitation est autorisée aux deux conditions suivantes : (1) l'appareil ne doit pas produire de brouillage, et (2) l'utilisateur de l'appareil doit accepter tout brouillage radioélectrique subi, même si le brouillage est susceptible d'en compromettre le fonctionnement.

Professional Apparatus

Apparatus for use in trades, professions or industries and which is not intended for sale to general public.
