

DASH

GUARDIAN

Quick Start Guide

v1.0.0

What's in the Box



Camera ×1



Power Cable ×1



Weather Foam Seal ×1



Mounting Plate ×1



Hardware Package ×1



Power Adapter ×1



Hole Guide ×1



QSG ×1

Know your Guardian

LED
LED Indicator



Lens



Built-in Mic

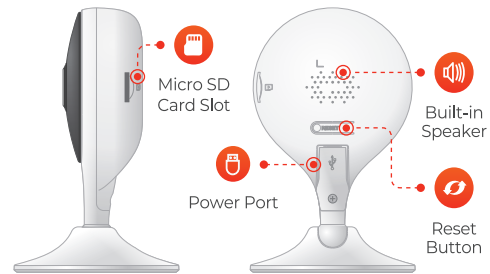

Note: Press & hold the reset button for 10s to reset the camera. The pattern of the LED indicator is included in the following table.

LED Indicator Status	Device Status
Off	<ul style="list-style-type: none">Powered off/LED turned offRebooting after reset
Red light on	<ul style="list-style-type: none">BootingDevice malfunction
Green light flashing	Waiting for network
Green light on	Operating properly
Red light flashing	Network connection failed
Green and Red light flashing alternately	Firmware updating

About the Guide

- This quick start guide is for reference only. Minor difference might be found in user interface.
- All the design and software here are subject to change without prior written notice.
- All trademarks & registered trademarks mentioned are the properties of their respective owners.
- Please visit our website or contact your local service engineer for more information.
- If there is any uncertainty or controversy, please refer to our final explanation.

Using the Dash App

Step 1

Scan the QR code or search "IC Realtime" in the Google Play or App Store to download & install DASH.



Step 2

Run the DASH App, and then register a new account if you do not already have one.

Step 3

Connect the camera to a power source.

Step 4

The camera LED indicator will flash green when it is fully booted on.

Step 5

With your mobile device connected to a 2.4 GHz band, follow the steps on the app to add a camera.

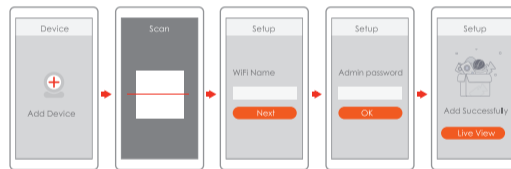

- Note:**
- Repeat step 5 for adding multiple cameras.
 - If camera fails to add or the WiFi connection is changed. Reset the camera and repeat step 5.

Camera Installation

Note: Make sure that the mounting surface can hold at least 1lb.

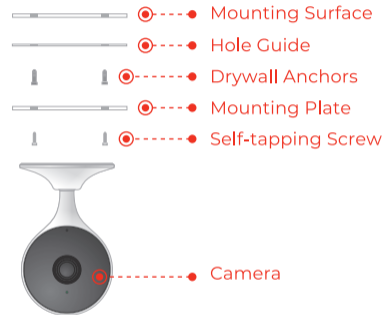

- Step 1** Use the guide to mark & drill holes for the drywall anchors.
- Step 2** Attach the mounting plate by drilling the provided screws into the anchors from step 1.
- Step 3** Attach the camera to the magnetic mounting plate, and adjust lens as needed.