

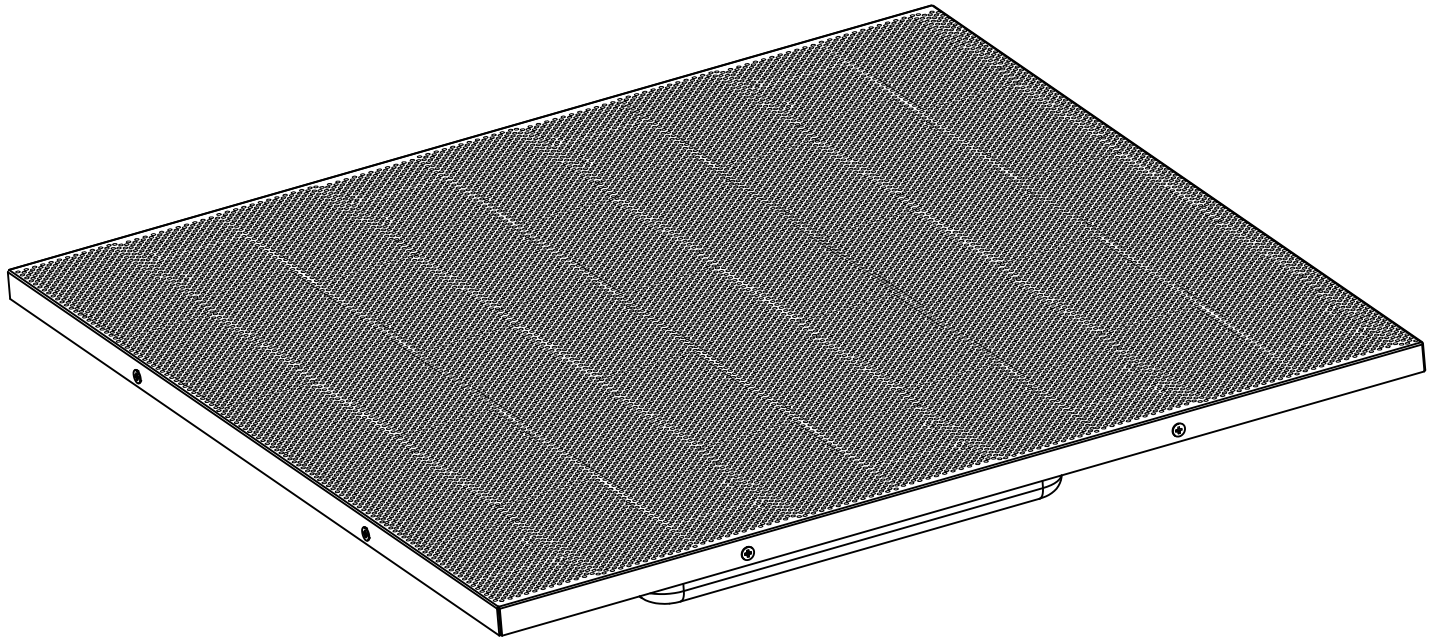

TS81-EZ | Install Instructions For:
TS81-EZ-BK & TS81-EZ-WH | Drop-In tile speaker



Box contents

- 1 Speaker
- 1 Conduit Connector (attached to speaker)
- Wire Nuts

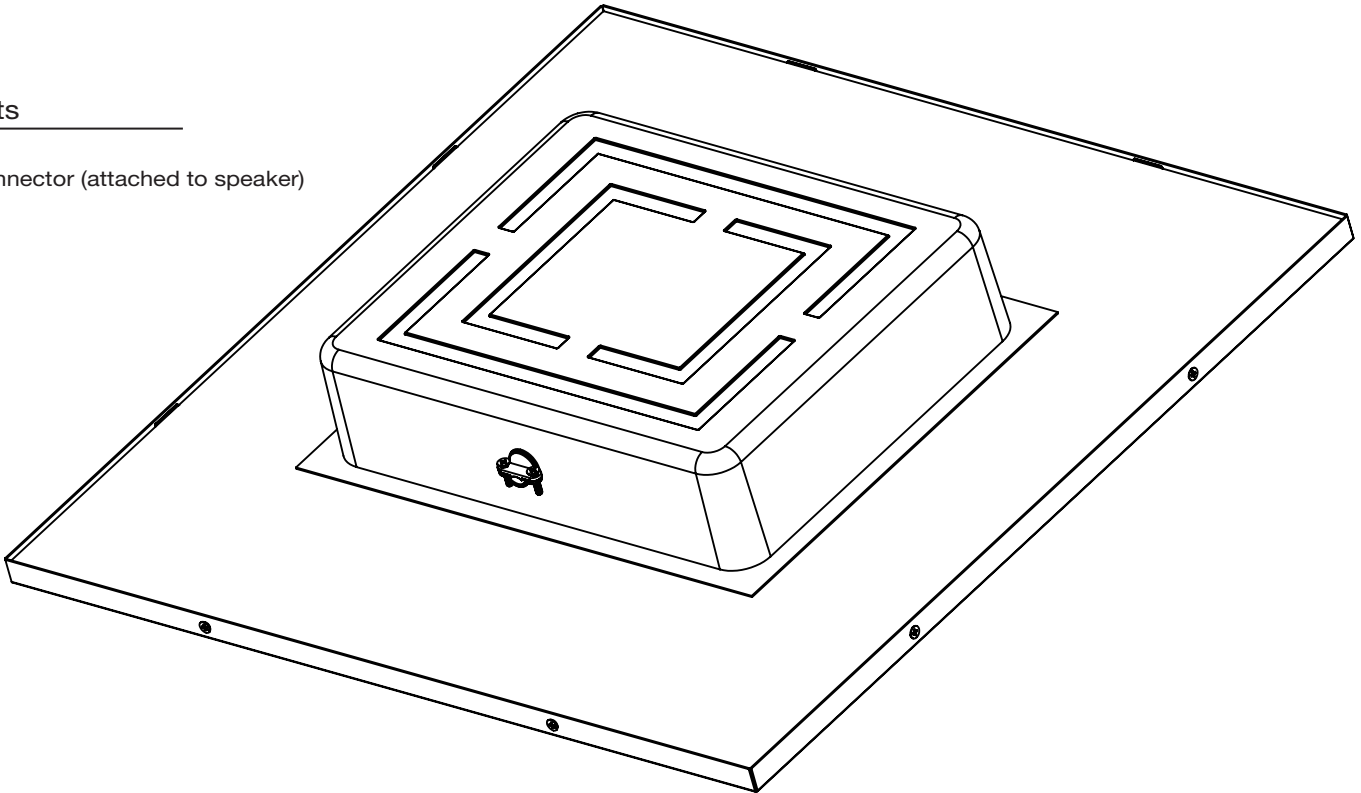

913.663.5600 | www.soundtube.com | www.mseaudio.com | sales@mseaudio.com

TS81-EZ

© 2019 SoundTube Entertainment, Inc. All rights reserved. PN INS-TS81-EZ Rev 03.20.19

Warning

SoundTube speakers must be installed by a professional audio installer/contractor. For safety and for optimum audio performance, installer must follow all directions issued by SoundTube Entertainment.

Warning

Do not spec or install speaker near support beam, ventilation duct or other structure that may interfere with speaker function or dispersion.

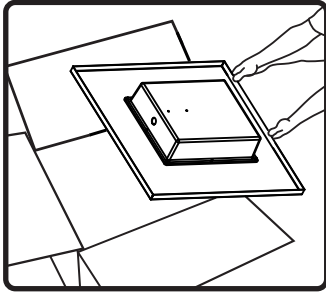

1. Unpack speaker.

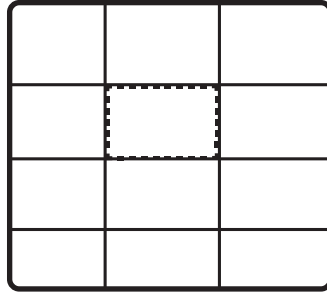

2. Determine the location to install the speaker. Be sure to ask your installer to ensure that the ceiling can support the weight of the speaker (5 kg / 11 lbs) before installation.

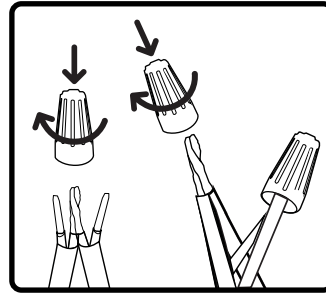

3. Using the included wire nuts and the wiring table below, connect the input source to the desired tap wires.

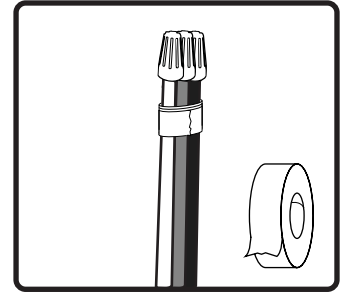

4. Cap the three unused wire ends with three wire nuts and tape the wires together. Push all three wires into the speaker cabinet.

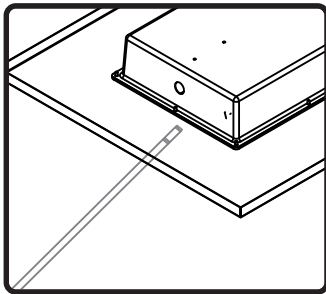

5. If using conduit, install flex conduit into the conduit connector.

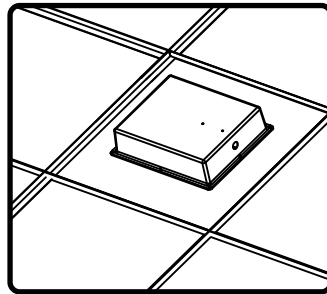

6. Place speaker in the tile grid.

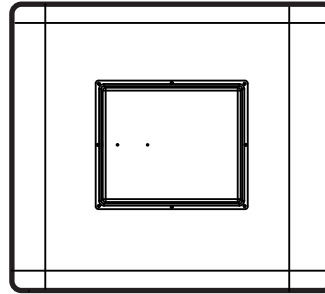

7. Done!

Frequency Response:
180 Hz - 20 kHz

	Black	Brown	Magenta	Orange	Yellow
100V	COM	*	10W	5W	2.5W
70V	COM	10W	5W	2.5W	1.25W
25V	COM	1.25W	0.63W	0.32W	0.16W

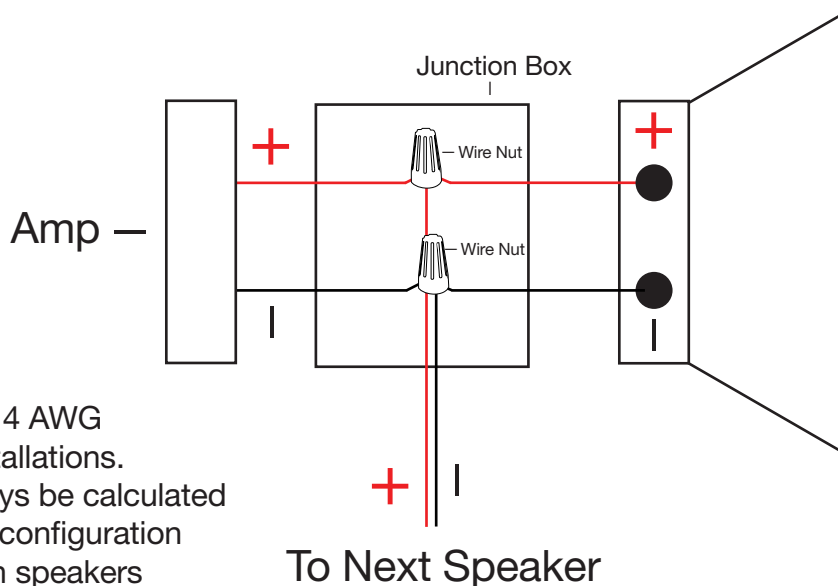

Recommend #18 - #14 AWG wire size for most installations. Wire size should always be calculated based on the system configuration and distance between speakers

+ Positive
- Negative