



Scan for full manual

VIACast Quick Start Guide

For Installer/Administrator



This guide helps you install and configure your **VIACast** for the first time.

Go to www.kramerav.com/downloads/VIACast to download the latest user manual and check if firmware upgrades are available.

Step 1: Check what's in the box

- ✓ VIACast dongle
- ✓ 1 Quick start guide

Step 2: Get to know your VIACast

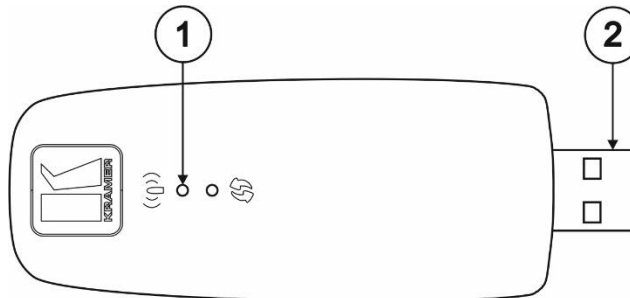

#	Feature	Function
1	Communication LED	Flashes slowly when enabled. Flashes quickly when a device is mirroring.
2	USB Connector	Connect to your VIA collaboration device.

This product complies with FCC Rule Part 47 CFR FCC Part 15 Subpart E § 15.407, FCC ID: Q87-WUSB6300.

Step 3: Install VIACast

- Plug the **VIACast** dongle into any of the USB ports on your VIA collaboration device.



VIACast is compatible with the following devices: VIA GO, VIA Connect PRO and VIA Connect PLUS.



Caution: There are no operator serviceable parts inside the unit.
See www.KramerAV.com for updated safety information.

Step 4: Enable VIACast

1. With the **VIACast** dongle plugged into your VIA collaboration device, turn on or reboot your VIA collaboration device.
2. Log in to your VIA device embedded web pages with a Web Administrator username (default = su) and password (default = supass).
The embedded web pages appear.
3. Click **VIA Management > VIA Settings** on the navigation pane.
The VIA Settings page appears with the System & IOS tab open.
4. In the Miracast® Settings section, click **ON**.
5. Click **Reset VIA Session**
VIACast is enabled and the **VIACast** communication LED flashes slowly.



Scan for full manual

VIAcast Quick Start Guide

For User

This guide helps you participate in a meeting using **VIAcast**.

Go to www.kramerav.com/downloads/VIAcast to download the latest user manual.



Mirror on VIA Main Display Using VIAcast

To mirror using **VIAcast** you need a Windows 10 laptop or an Android device that supports Miracast.



If the drivers of your Windows10 laptop are up to date and the “Connect to a wireless display” option is not available, your device does not support Miracast.



Android operating system versions 4.2 and higher include built-in Miracast technology. However, some Android 4.2 and 4.3 devices do not support Miracast.

For Windows laptop:

1. On your Windows laptop, press Windows + P. The Project options appear.

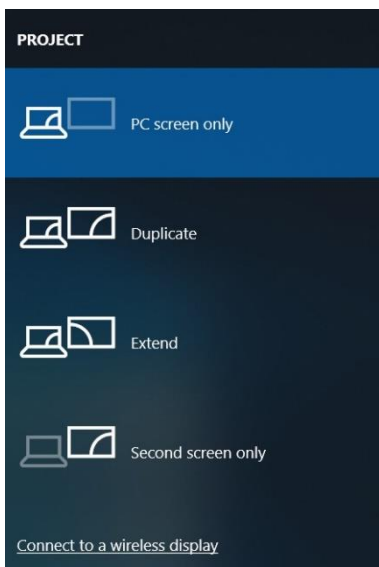

2. Click **Connect to a wireless display**. The Room Name of your VIA collaboration device appears in the Connect list.

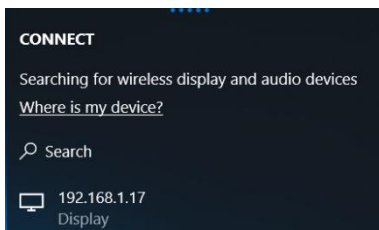

3. Click the Room Name of your VIA device. A PIN code field appears (if Code was activated on your VIA device).
4. Enter the Code that appears on the main display and click **Connect**. The name of your device appears on the main display and then your screen is mirrored on the main display.

For Android:

1. In your Android device settings, open Wi-Fi Direct or Miracast. Device options appear on your screen.

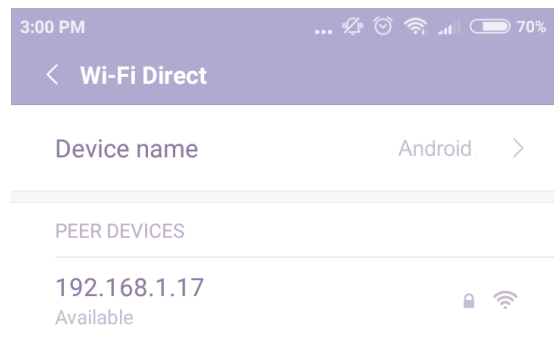

2. Click the Room Name of your VIA collaboration device. A PIN code field appears (if Code was activated on your VIA device).

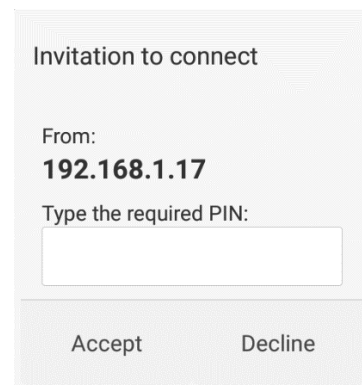

3. Enter the Code that appears on the main display and click **Accept/Connect**. The name of your device appears on the main display and then your screen is mirrored on the main display.